

# DORSEY RUN ROAD EXTENSION

## MD 175 TO DORSEY RUN INDUSTRIAL CENTER ELECTION DISTRICT 1 HOWARD COUNTY, MARYLAND CAPITAL PROJECT J-4148-C

### INDEX OF DRAWINGS

- 1 TITLE SHEET
- 2-3 PLAN AND PROFILE (2 SHEETS)
- 4 SITE ACCESS PLAN
- 5 EROSION & SEDIMENT CONTROL DETAILS & NOTES I
- 6-7 CROSS SECTIONS

43EA  
EL. 242.20  
N 546593.973  
E 1373621.750

43HB  
EL. 261.63  
N 543166.747  
E 1374425.040

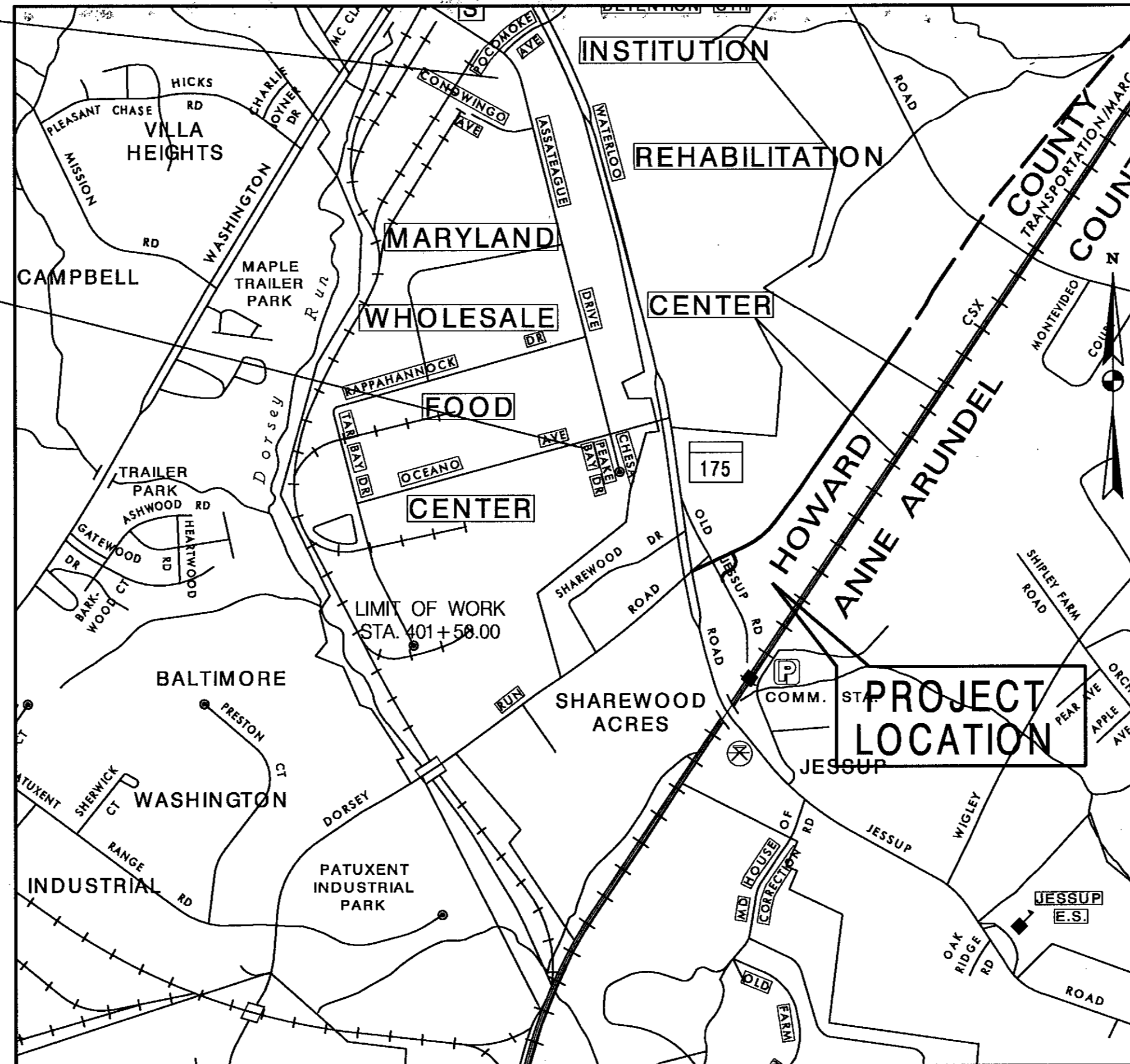

### GENERAL NOTES

1. THE CONTRACTOR SHALL NOTIFY THE HOWARD COUNTY DEPARTMENT OF PUBLIC WORKS/BUREAU OF ENGINEERING CONSTRUCTION INSPECTION DIVISION AT 410-313-1880 AND MISS UTILITY AT 1-800-257-7777 AT LEAST FIVE (5) WORKING DAYS BEFORE STARTING WORK.
2. THE SYSTEM OF COORDINATES USED BY HOWARD COUNTY IS BASED IN THE FOLLOWING DATUMS AND PROJECTIONS:  
HORIZONTAL: MARYLAND NAD83 (ADJ 1991)  
VERTICAL: NAVD88  
HOWARD COUNTY CONTROL:  
STATION NO. 43 EA (ELEV. 242.20), N 546,593.973, E 1,373,621.750  
STATION NO. 43 HB (ELEV. 261.63), N 543,166.747, E 1,374,425.040.
3. ALL ELEVATIONS SHOWN ARE BASED ON THE U.S.C. AND G.S. MEAN SEA LEVEL DATUM, 1988.
4. ALL CONSTRUCTION SHALL BE IN ACCORDANCE WITH THE LATEST STANDARDS AND SPECIFICATIONS OF HOWARD COUNTY.
5. ALL WORK SHALL COMPLY WITH ALL APPLICABLE PROVISIONS OF THE '1994 MARYLAND STANDARDS AND SPECIFICATIONS FOR SOIL EROSION AND SEDIMENT CONTROL,' ISSUED BY THE MARYLAND DEPARTMENT OF THE ENVIRONMENT AND THE NATURAL RESOURCES CONSERVATION SERVICE.
6. TOPOGRAPHIC SURVEYS WERE PERFORMED BY URS CORPORATION IN JUNE 2005.
7. THE PROPERTY LINES AND EASEMENTS FOR THIS PROJECT ARE SHOWN ON PLATS J-4148-01, J-4148-02, J-4148-03, J-4148-04, J-4148-05, J-4148-06, J-4148-07.
8. SHOULD THE CONTRACTOR DISCOVER DISCREPANCIES BETWEEN THE PLANS AND THE FIELD CONDITIONS, THE ENGINEER IS TO BE NOTIFIED IMMEDIATELY TO RESOLVE THE SITUATION. SHOULD THE CONTRACTOR MAKE FIELD CORRECTIONS OR ADJUSTMENTS WITHOUT NOTIFYING THE ENGINEER, THEN THE CONTRACTOR ASSUMES ALL RESPONSIBILITY FOR THOSE CHANGES.
9. CONTRACTOR IS SOLELY RESPONSIBLE FOR CONSTRUCTION MEANS, METHOD, TECHNIQUES, SEQUENCES, PROCEDURES, AND SAFETY PRECAUTIONS AND PROGRAMS.
10. APPROXIMATE UTILITIES ARE SHOWN FROM AVAILABLE RECORDS. THE CONTRACTOR SHALL TAKE ALL NECESSARY PRECAUTIONS TO PROTECT THE EXISTING UTILITIES AND MAINTAIN UNINTERRUPTED SERVICE. ANY DAMAGE INCURRED DUE TO CONTRACTOR'S OPERATION SHALL BE REPAIRED IMMEDIATELY AT THE CONTRACTOR'S EXPENSE.

#### UTILITY CONTACTS:

BGE: (410)-597-7835 (ELECTRIC)  
BGE: (410)-291-5101 (GAS)  
VERIZON: (410)-224-9285  
MCH: (912)-729-6016  
XPELUS: (703)-386-2340  
ABOVENET: (443)-250-1873  
COMCAST: (410)-513-3207

- II. ALL PIPE ELEVATIONS SHOWN ARE INVERT ELEVATIONS.

#### DEVELOPER'S CERTIFICATION

"I/WE CERTIFY THAT ALL DEVELOPMENT AND CONSTRUCTION WILL BE DONE ACCORDING TO THIS PLAN, AND THAT ANY RESPONSIBLE PERSONNEL INVOLVED IN THE CONSTRUCTION PROJECT WILL HAVE A CERTIFICATE OF ATTENDANCE AT A DEPARTMENT OF THE ENVIRONMENT APPROVED TRAINING PROGRAM FOR THE CONTROL OF SEDIMENT AND EROSION BEFORE BEGINNING THE PROJECT. I ALSO AUTHORIZE PERIODIC ON-SITE INSPECTION BY THE HOWARD SOIL CONSERVATION DISTRICT."

*Steve Shayan*  
SIGNATURE OF DEVELOPER

2/25/14  
DATE

EP-06-009

#### ENGINEER'S CERTIFICATION

"I CERTIFY THAT THIS PLAN FOR EROSION AND SEDIMENT CONTROL REPRESENTS A PRACTICAL AND WORKABLE PLAN BASED ON MY PERSONAL KNOWLEDGE OF THE SITE CONDITIONS AND THAT IT WAS PREPARED IN ACCORDANCE WITH THE REQUIREMENTS OF THE HOWARD SOIL CONSERVATION DISTRICT."

*[Signature]*  
URS CORPORATION  
4 NORTH PARK DRIVE  
HUNT VALLEY, MD 21030  
2-21-2014  
DATE

THE DEVELOPMENT IS APPROVED FOR EROSION AND SEDIMENT CONTROL BY HOWARD SOIL CONSERVATION DISTRICT.

*[Signature]*  
HOWARD SOIL CONSERVATION DISTRICT  
3/12/14  
DATE

Professional Certification: I hereby certify that these documents were prepared and/or approved by me, and that I am a duly licensed professional engineer under the laws of the State of Maryland.  
License No. 16156 Expiration Date: 9-28-14

#### DEPARTMENT OF PUBLIC WORKS

*[Signature]* 2/25/14  
DIRECTOR OF PUBLIC WORKS DATE  
*Steve Shayan* 2/25/14  
CHIEF, DIVISION OF TRANSPORTATION AND SPECIAL PROJECTS DATE

*[Signature]* 2/25/14  
CHIEF, BUREAU OF ENGINEERING DATE  
*[Signature]* 2-27-14  
CHIEF, BUREAU OF HIGHWAYS DATE

PREPARED BY  
**URS**  
4 NORTH PARK DRIVE  
HUNT VALLEY, MARYLAND  
TEL: (410) 785-7220

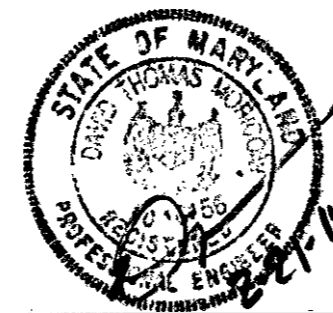

DES: DTM			
DRN: SYC/CFD			
CHK: DTM			
DATE: 10/06			
BY NO.		REVISION	DATE

TITLE SHEET

SCALE: MAP NO. N/A BLOCK NO.

DORSEY RUN ROAD EXTENSION  
MD 175 TO  
DORSEY RUN INDUSTRIAL CENTER  
ELECTION DISTRICT NO. 1 - JESSUP, MARYLAND  
CAPITAL PROJECT J-4148-C

SCALE AS NOTED  
SHEET 1 OF 7

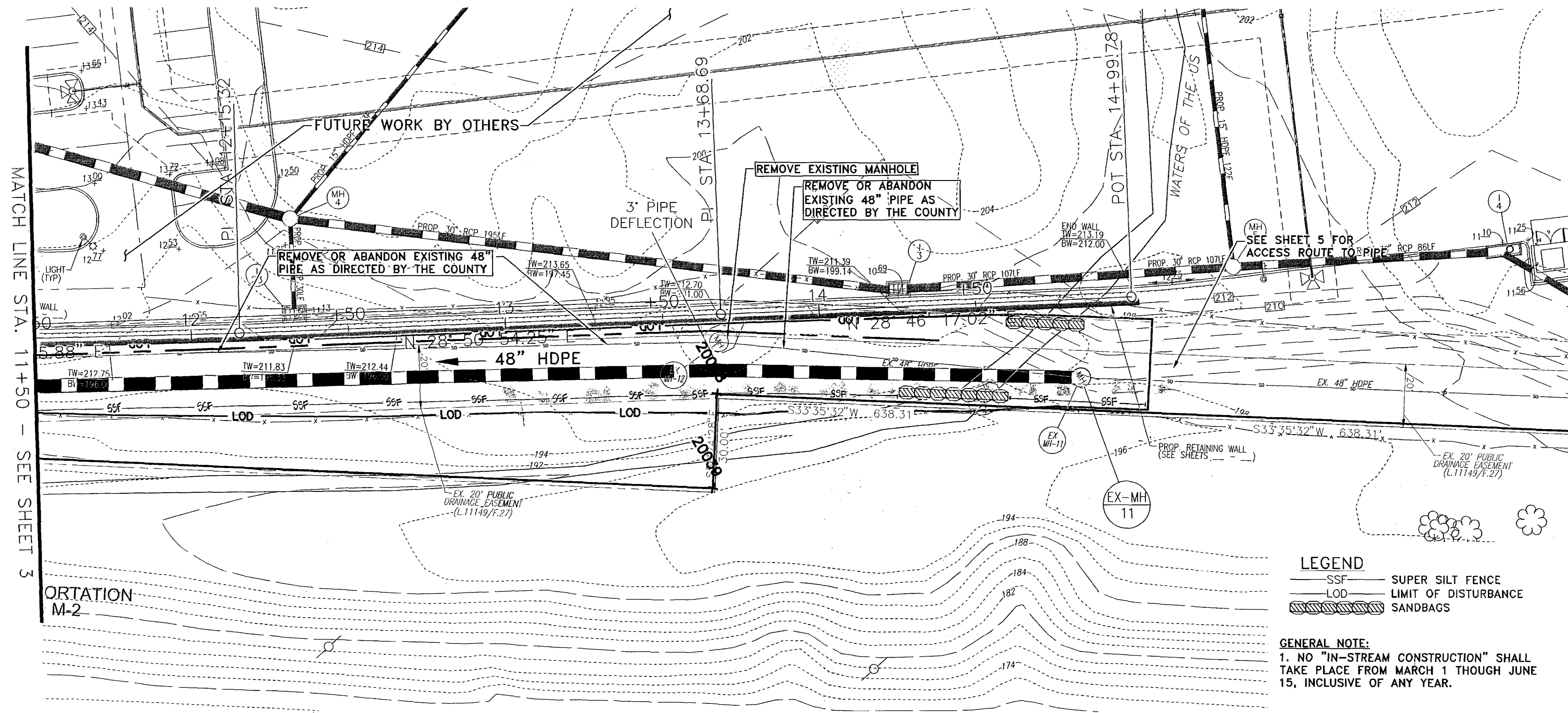

DRAINAGE PIPE SCHEDULE			
FROM STRUCTURE	TO STRUCTURE	LENGTH (FT.)	SIZE (IN.) TYPE
EX MH-11	MH-12	370.00	48 HDPE
MH-12	ES-7	182.00	48 HDPE

DRAINAGE STRUCTURE SCHEDULE					
STRUCTURE NO.	INV. IN	INV. OUT	TOP ELEV.	TYPE	STD. REF.
MH-12	187.09	186.30	194.08	72" PRECAST MANHOLE	MD 384.05

DRAINAGE STRUCTURE COORDINATES				
STRUCTURE	NORTHING	EASTING	STATION	OFFSET
3" DEFLECTION	542,504.96	1,376,676.61	13+67.62	17.86, RT
MH-12	542,283.26	1,376,549.63	11+12.37	15.13, RT
ES-7	542,121.59	1,376,545.55	9+25.89	20.49, RT

BASELINE COORDINATES			
POINT	NORTHING	EASTING	BEARING
POINT 1	542027.68	1376368.25	N 33° 20' 09.01" E
POINT 2	542235.78	1376505.13	N 29° 41' 45.88" E
POINT 3	542380.18	1376587.48	N 28° 50' 54.25" E
POINT 4	542514.52	1376661.48	N 28° 46' 17.02" E
POINT 5	542629.42	1376724.58	

**BY THE DEVELOPER:**  
 I / WE CERTIFY THAT ALL DESIGN AND/OR CONSTRUCTION WILL BE DONE ACCORDING TO THESE PLANS, AND THAT ANY RESPONSIBLE PERSONNEL INVOLVED IN THE CONSTRUCTION PROJECT WILL HAVE A CERTIFICATE OF ATTENDANCE AT A DEPARTMENT OF THE ENVIRONMENT APPROVED TRAINING PROGRAM FOR THE CONTROL OF SEDIMENT AND EROSION BEFORE BEGINNING THE PROJECT. I SHALL ENGAGE A REGISTERED PROFESSIONAL ENGINEER TO SUPERVISE POND CONSTRUCTION AND PROVIDE THE HOWARD SOIL CONSERVATION DISTRICT WITH AN "AS-BUILT" PLAN OF THE POND WITHIN 30 DAYS OF COMPLETION. I ALSO AUTHORIZE PERIODIC ON-SITE INSPECTIONS BY THE HOWARD SOIL CONSERVATION DISTRICT.

*Steve Slavan* 2/25/14  
 DEVELOPER DATE

**BY THE ENGINEER:**  
 I CERTIFY THAT THIS PLAN FOR STORM DRAIN CONSTRUCTION AND SEDIMENT CONTROL REPRESENTS A PRACTICAL AND WORKABLE PLAN BASED ON MY PERSONAL KNOWLEDGE OF THE SITE CONDITIONS. THIS PLAN WAS PREPARED IN ACCORDANCE WITH THE REQUIREMENTS OF THE HOWARD SOIL CONSERVATION DISTRICT.

*David T. Moriconi* 2-21-14  
 ENGINEER DATE

THE DEVELOPMENT IS APPROVED FOR EROSION AND SEDIMENT CONTROL BY HOWARD SOIL CONSERVATION DISTRICT.  
*John R. Robinson* 3/29/14  
 HOWARD SOIL CONSERVATION DISTRICT DATE

**LEGEND**  
 SSF SUPER SILT FENCE  
 LOD LIMIT OF DISTURBANCE  
 SANDBAGS

**GENERAL NOTE:**  
 1. NO "IN-STREAM CONSTRUCTION" SHALL TAKE PLACE FROM MARCH 1 THROUGH JUNE 15, INCLUSIVE OF ANY YEAR.

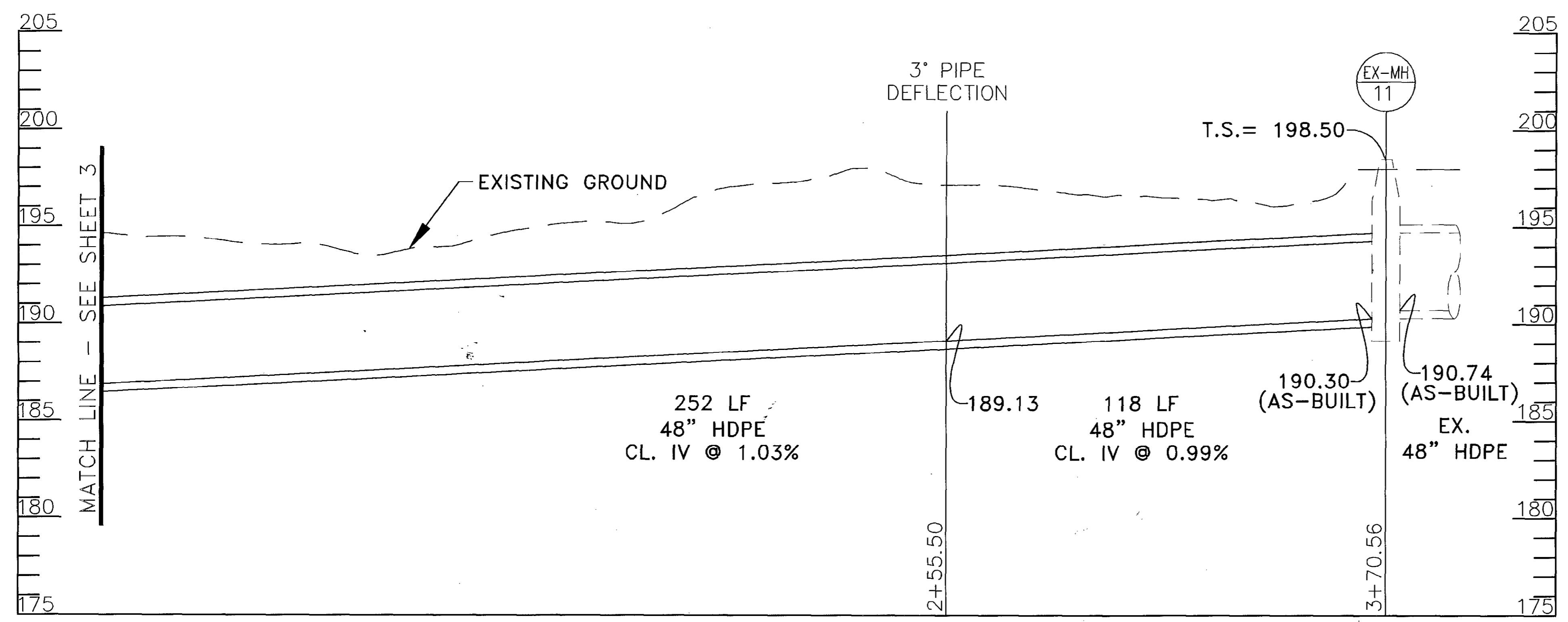

EX-MH 11 TO ES-7  
 SCALE: HORZ.= 1"=30'  
 VERT.= 1"=5'

DEPARTMENT OF PUBLIC WORKS <i>Steve Slavan</i> 2/25/14 DIRECTOR OF PUBLIC WORKS DATE <i>Steve Slavan</i> 2/25/14 CHIEF, DIVISION OF TRANSPORTATION AND SPECIAL PROJECTS DATE		PREPARED BY <b>URS</b> 4 NORTH PARK BLVD. HUNT VALLEY, MARYLAND TEL: (410) 780-7820		DES: RLL DRN: CDF CHK: DTM DATE: 11/12		PLAN AND PROFILE PLAN SCALE MAP NO. N/A BLOCK NO.		DORSEY RUN ROAD EXTENSION MD 175 TO DORSEY RUN INDUSTRIAL CENTER ELECTION DISTRICT NO. 1 - JESSUP, MARYLAND CAPITAL PROJECT J-4148		SCALE 1"=20' SHEET 2 OF 7
<i>Mona B. Butler</i> 2/27/14 CHIEF, BUREAU OF ENGINEERING DATE <i>Wes Law</i> 2-27-14 CHIEF, BUREAU OF HIGHWAYS DATE		STATE OF MARYLAND ENGINEER'S SEAL <i>David T. Moriconi</i> 2-21-14		DTM 1 ADDED SSF 3/17/14 BY NO. REVISION DATE		SCALE MAP NO. N/A BLOCK NO.				

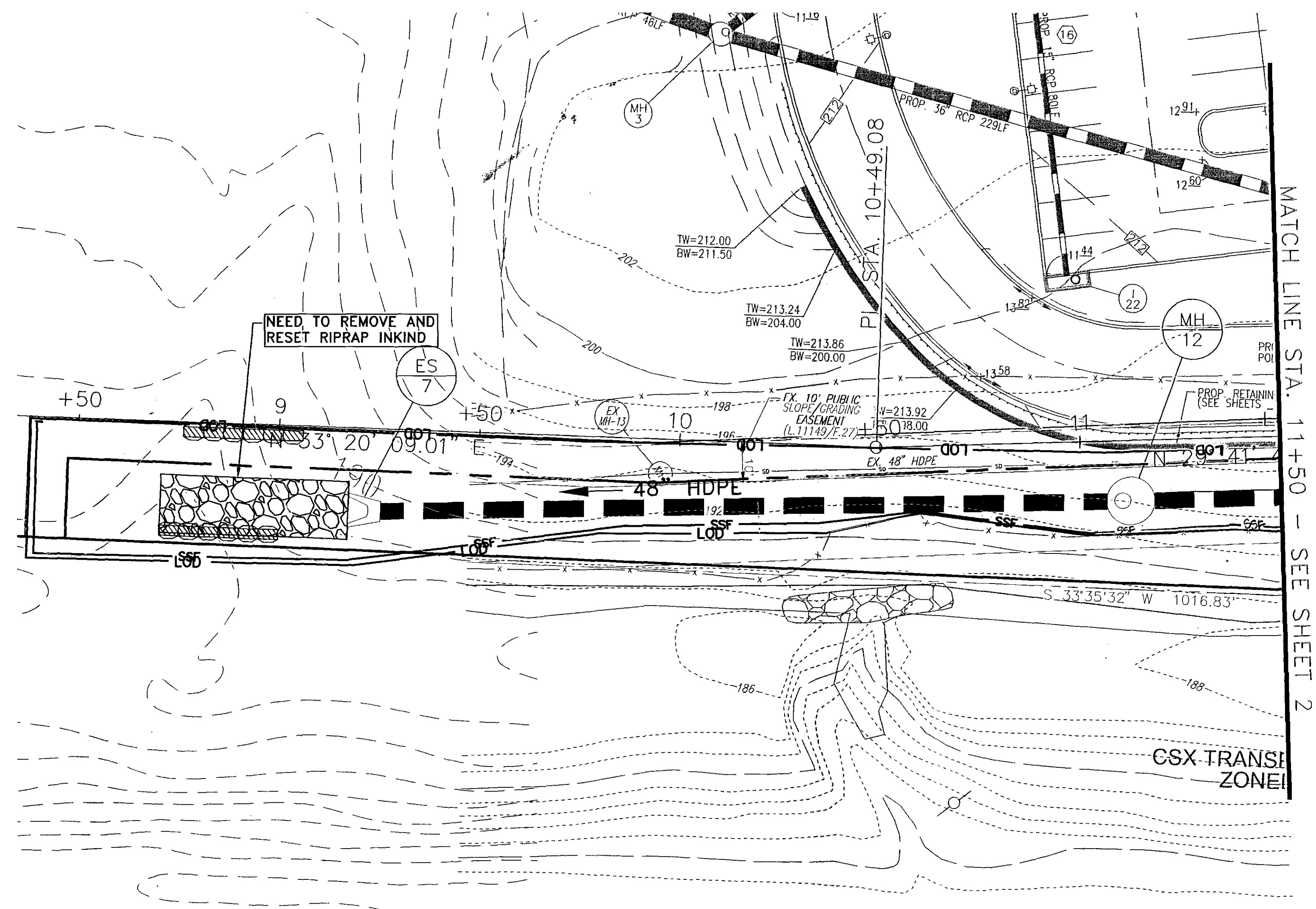

MATCH LINE STA. 11+50 - SEE SHEET 2

- LEGEND**
- SSF SUPER SILT FENCE
  - LOD LIMIT OF DISTURBANCE
  - SANDBAGS

**GENERAL NOTE:**  
 1. NO "IN-STREAM CONSTRUCTION" SHALL TAKE PLACE FROM MARCH 1 THROUGH JUNE 15, INCLUSIVE OF ANY YEAR.

BY THE DEVELOPER:  
 I / WE CERTIFY THAT ALL DEVELOPMENT AND/OR CONSTRUCTION WILL BE DONE ACCORDING TO THESE PLANS, AND THAT ANY RESPONSIBLE PERSONNEL INVOLVED IN THE CONSTRUCTION PROJECT WILL HAVE A CERTIFICATE OF ATTENDANCE AT A DEPARTMENT OF THE ENVIRONMENT APPROVED TRAINING PROGRAM FOR THE CONTROL OF SEDIMENT AND EROSION BEFORE BEGINNING THE PROJECT. I SHALL ENGAGE A REGISTERED PROFESSIONAL ENGINEER TO SUPERVISE POND CONSTRUCTION AND PROVIDE THE HOWARD SOIL CONSERVATION DISTRICT WITH AN "AS-BUILT" PLAN OF THE POND WITHIN 30 DAYS OF COMPLETION. I ALSO AUTHORIZE PERIODIC ON-SITE INSPECTIONS BY THE HOWARD SOIL CONSERVATION DISTRICT.

Steve Shanaw 2/25/14  
 DEVELOPER DATE

BY THE ENGINEER:  
 I CERTIFY THAT THIS PLAN FOR STORM DRAIN CONSTRUCTION AND SEDIMENT CONTROL REPRESENTS A PRACTICAL AND WORKABLE PLAN BASED ON MY PERSONAL KNOWLEDGE OF THE SITE CONDITIONS. THIS PLAN WAS PREPARED IN ACCORDANCE WITH THE REQUIREMENTS OF THE HOWARD SOIL CONSERVATION DISTRICT.

DAVID T. MORICONI 2-21-14  
 ENGINEER DATE

THE DEVELOPMENT IS APPROVED FOR EROSION AND SEDIMENT CONTROL BY HOWARD SOIL CONSERVATION DISTRICT.  
 John R. Valentin 3/20/14  
 HOWARD SOIL CONSERVATION DISTRICT DATE

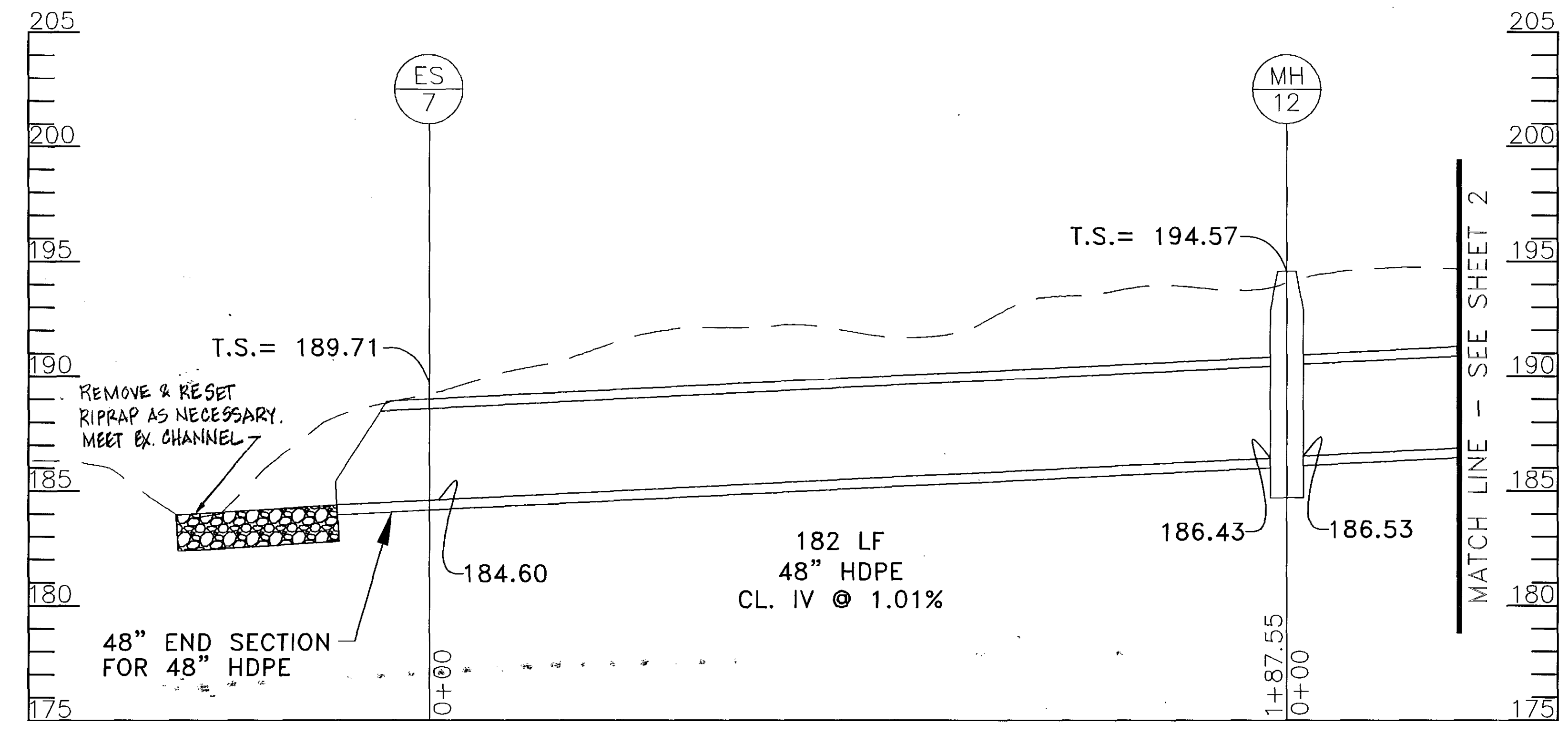

EX-MH 11 TO ES-7  
 SCALE: HORZ. = 1"=30'  
 VERT. = 1"=5'

DEPARTMENT OF PUBLIC WORKS

Steve Shanaw 2/25/14  
 DIRECTOR OF PUBLIC WORKS DATE

Maria E. Butler 2/25/14  
 CHIEF, BUREAU OF ENGINEERING DATE

Steve Shanaw 2/25/14  
 CHIEF, DIVISION OF TRANSPORTATION AND SPECIAL PROJECTS DATE

Wendy Z. Smith 2-27-14  
 CHIEF, BUREAU OF HIGHWAYS DATE

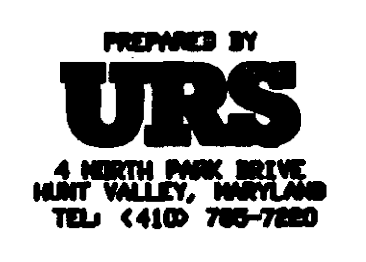

DES: RLL			
DRN: CDF			
CHK: DTM			
DATE: 11/12	BY NO.	REVISION	DATE

PLAN AND PROFILE PLAN

DORSEY RUN ROAD EXTENSION  
 MD 175 TO  
 DORSEY RUN INDUSTRIAL CENTER  
 ELECTION DISTRICT NO. 1 - JESSUP, MARYLAND  
 CAPITAL PROJECT J-4148

SCALE  
 1"=20'

SHEET  
 3 OF 7

**ENGINEER'S CERTIFICATE**  
 "I certify that this plan for pond construction and for sediment and erosion control represents a practical and workable plan based on my personal knowledge of the site conditions. This plan was prepared in accordance with the requirements of the Howard Soil Conservation District. I have notified the developer that he/she must engage a registered professional engineer to supervise pond construction and provide the Howard Soil Conservation District with an "as-built" plan of the pond within 30 days of completion.

*DAVID T. MORGAN* 2/21/14  
 Signature of Engineer (print name below signature) Date

**DEVELOPER'S CERTIFICATE**  
 "I/We certify that all development and construction will be done according to these plans, and that any responsible personnel involved in the construction of this project will have a Certificate of Attendance at a Department of Environment Approved Training Program for the Control of Sediment and Erosion before beginning the project. I also authorize periodic on-site inspection by the Howard Soil Conservation District. I shall engage a registered professional engineer to supervise pond construction and provide the Howard Soil Conservation District with an "as-built" plan of the pond within 30 days of completion.

*Steve Slagov* 2/25/14  
 Signature of Developer (print name below signature) Date

THE DEVELOPMENT IS APPROVED FOR EROSION AND SEDIMENT CONTROL BY HOWARD SOIL CONSERVATION DISTRICT.  
*John L. Johnson* 3/20/14  
 HOWARD SOIL CONSERVATION DISTRICT DATE

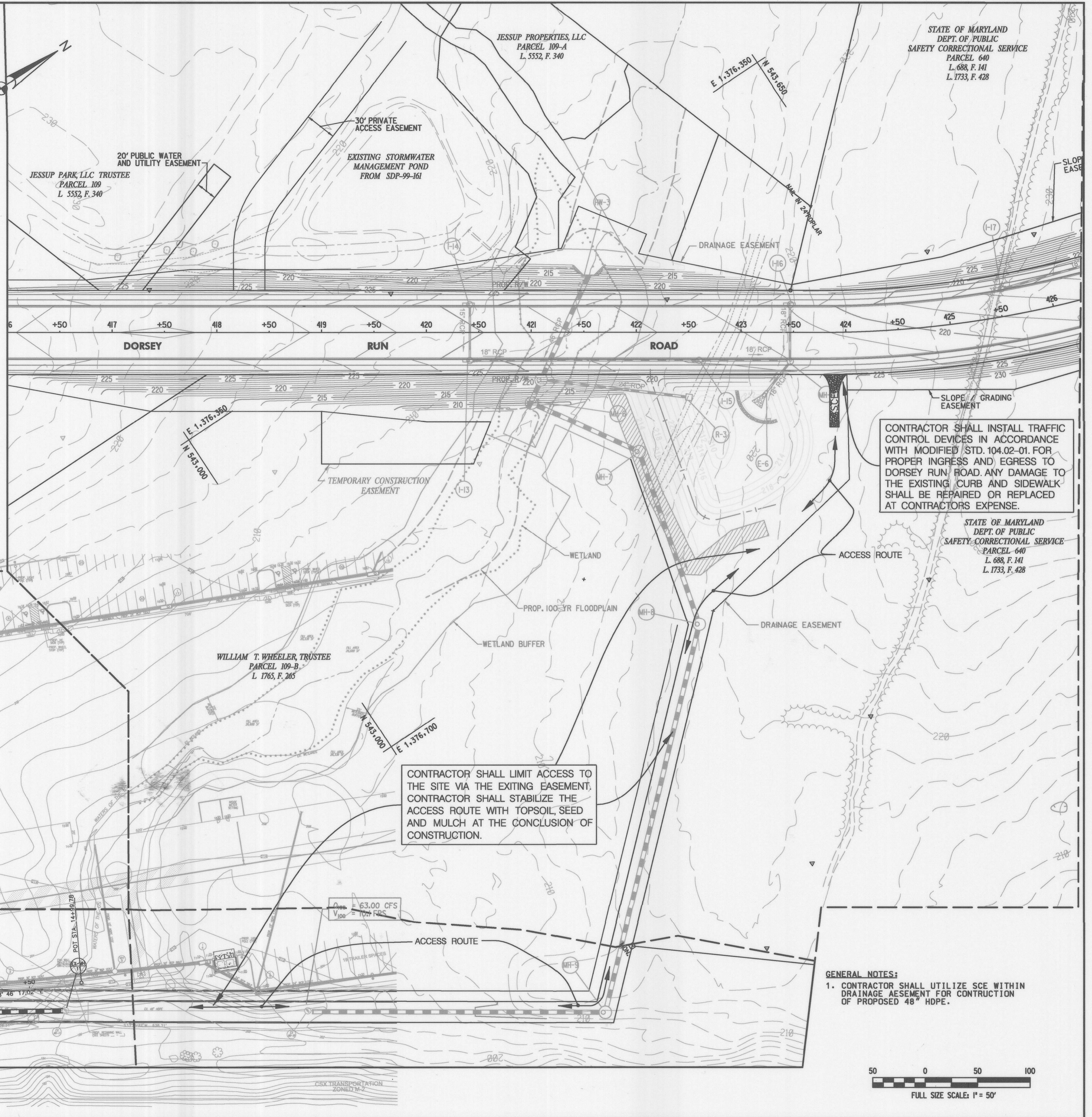
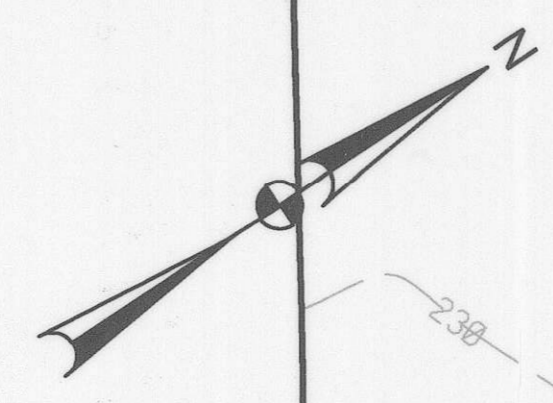

CONTRACTOR SHALL INSTALL TRAFFIC CONTROL DEVICES IN ACCORDANCE WITH MODIFIED STD. 104.02-01 FOR PROPER INGRESS AND EGRESS TO DORSEY RUN ROAD. ANY DAMAGE TO THE EXISTING CURB AND SIDEWALK SHALL BE REPAIRED OR REPLACED AT CONTRACTORS EXPENSE.

CONTRACTOR SHALL LIMIT ACCESS TO THE SITE VIA THE EXISTING EASEMENT. CONTRACTOR SHALL STABILIZE THE ACCESS ROUTE WITH TOPSOIL, SEED AND MULCH AT THE CONCLUSION OF CONSTRUCTION.

**GENERAL NOTES:**  
 1. CONTRACTOR SHALL UTILIZE SCE WITHIN DRAINAGE EASEMENT FOR CONSTRUCTION OF PROPOSED 48" HDPE.

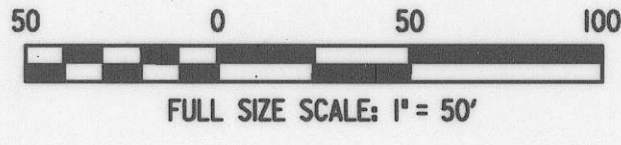

<b>DEPARTMENT OF PUBLIC WORKS</b> <i>John L. Johnson</i> 3/20/14 DIRECTOR OF PUBLIC WORKS DATE <i>Steve Slagov</i> 2/25/14 CHIEF, DIVISION OF TRANSPORTATION AND SPECIAL PROJECTS DATE		PREPARED BY <b>URS</b> 4 NORTH PARK DRIVE HUNT VALLEY, MARYLAND TEL: (410) 785-7220				DES: DTM DRN: SYC/CFD CHK: DTM DATE: 10/06		<b>SITE LAYOUT PLAN</b>		<b>DORSEY RUN ROAD EXTENSION</b> MD 175 TO DORSEY RUN INDUSTRIAL CENTER ELECTION DISTRICT NO. 1 - JESSUP, MARYLAND CAPITAL PROJECT J-4148-C		SCALE SHEET 4 OF 7
				BY NO. REVISION DATE		SCALE MAP NO. N/A BLOCK NO.						

**PERMANENT SEEDING NOTES \*\***

APPLY TO GRADED OR CLEARED AREAS NOT SUBJECT TO IMMEDIATE FURTHER DISTURBANCE WHERE A PERMANENT LONG-LIVED VEGETATIVE COVER IS NEEDED.

SEEDBED PREPARATION: LOOSEN UPPER 3 INCHES OF SOIL BY RAKING, DISCING, OR OTHER ACCEPTABLE MEANS BEFORE SEEDING. IF NOT PREVIOUSLY LOOSENED.

SOIL AMENDMENTS: IN LIEU OF SOIL TEST RECOMMENDATIONS, USE ONE OF THE FOLLOWING SCHEDULES:

1) PREFERRED - APPLY 2 TONS PER ACRE DOLOMITIC LIMESTONE (92 LBS. PER 1,000 SQUARE FEET) AND 600 LBS. PER ACRE 10-10-10 FERTILIZER (14 LBS. PER 1,000 SQUARE FEET) BEFORE SEEDING. HARROW OR DISC INTO UPPER 3 INCHES OF SOIL. AT TIME OF SEEDING, APPLY 400 LBS. PER ACRE 30-0-0 UREAFORM FERTILIZER (9 LBS. PER 1,000 SQUARE FEET).

2) ACCEPTABLE - APPLY 2 TONS PER ACRE DOLOMITIC LIMESTONE (92 LBS. PER 1,000 SQUARE FEET) AND 1,000 LBS. PER ACRE 10-10-10 FERTILIZER (23 LBS. PER 1,000 SQUARE FEET) BEFORE SEEDING. HARROW OR DISC INTO UPPER 3 INCHES OF SOIL.

SEEDING: FOR THE PERIOD MARCH 1 THROUGH APRIL 30 AND FROM AUGUST 1 THROUGH OCTOBER 15, SEED WITH 60 LBS. PER ACRE (14 LBS. PER 1,000 SQUARE FEET) OF KENTUCKY 31 TALL FESCUE. FOR THE PERIOD MAY 1 THROUGH JULY 31, SEED WITH 60 LBS. KENTUCKY 31 TALL FESCUE PER ACRE AND 2 LBS. PER ACRE (0.05 LBS. PER 1,000 SQUARE FEET) OF WEEPING LOVEGRASS. DURING THE PERIOD OCTOBER 16 THROUGH FEBRUARY 28, PROTECT SITE BY ONE OF THE FOLLOWING OPTIONS:

1) 2 TONS PER ACRE OF WELL-ANCHORED MULCH STRAW AND SEED AS SOON AS POSSIBLE IN THE SPRING.  
2) USE SOD.  
3) SEED WITH 60 LBS. PER ACRE KENTUCKY 31 TALL FESCUE AND MULCH WITH 2 TONS PER ACRE WELL-ANCHORED STRAW.

MULCHING: APPLY 1/2 TO 2 TONS PER ACRE (70 TO 90 LBS. PER 1,000 SQUARE FEET) OF UNROTTED SMALL GRAIN STRAW IMMEDIATELY AFTER SEEDING. ANCHOR MULCH IMMEDIATELY AFTER APPLICATION USING MULCH ANCHORING TOOL OR 218 GALLONS PER ACRE (5 GALLONS PER 1,000 SQUARE FEET) OF EMULSIFIED ASPHALT ON FLAT AREAS, ON SLOPES, 8 FEET OR HIGHER, USE 347 GALLONS PER ACRE (8 GALLONS PER 1,000 SQUARE FEET) FOR ANCHORING.

MAINTENANCE: INSPECT ALL SEEDING AREAS AND MAKE NEEDED REPAIRS, REPLACEMENTS, AND RESEEDINGS.  
TEMPORARY SEEDING NOTES  
APPLY TO GRADED OR CLEARED AREAS LIKELY TO BE REDISTRIBUTED WHERE A SHORT-TERM VEGETATIVE COVER IS NEEDED.

SEEDBED PREPARATION: LOOSEN UPPER 3 INCHES OF SOIL BY RAKING, DISCING, OR OTHER ACCEPTABLE MEANS BEFORE SEEDING.

SOIL AMENDMENTS: APPLY 600 LBS. PER ACRE 10-10-10 FERTILIZER (14 LBS. PER 1,000 SQUARE FEET).

SEEDING: FOR PERIODS MARCH 1 THROUGH APRIL 30 AND FROM AUGUST 15 THROUGH NOVEMBER 15, SEED WITH 2 1/2 BUSHELS PER ACRE OF ANNUAL RYE (3.2 LBS. PER 1,000 SQUARE FEET). FOR THE PERIOD MAY 1 THROUGH AUGUST 14, SEED WITH 3 LBS. PER ACRE OF WEEPING LOVEGRASS (0.07 LBS. PER 1,000 SQUARE FEET). FOR THE PERIOD NOVEMBER 16 THROUGH FEBRUARY 28, PROTECT SITE BY APPLYING 2 TONS PER ACRE OF WELL-ANCHORED STRAW MULCH AND SEED AS SOON AS POSSIBLE IN THE SPRING OR USE SOD.

MULCHING: APPLY 1/2 TO 2 TONS PER ACRE (70 TO 90 LBS. PER 1,000 SQUARE FEET) OF UNROTTED SMALL GRAIN STRAW IMMEDIATELY AFTER SEEDING. ANCHOR MULCH IMMEDIATELY AFTER APPLICATION USING MULCH ANCHORING TOOL OR 218 GALLONS PER ACRE (5 GALLONS PER 1,000 SQUARE FEET) OF EMULSIFIED ASPHALT ON FLAT AREAS, ON SLOPES, 8 FEET OR HIGHER, USE 347 GALLONS PER ACRE (8 GALLONS PER 1,000 SQUARE FEET) FOR ANCHORING. REFER TO THE 1994 MARYLAND STANDARDS AND SPECIFICATIONS FOR SOIL EROSION AND SEDIMENT CONTROL FOR RATE AND METHODS NOT COVERED.

Stabilization must be completed within: a) 3 calendar days to all perimeter controls, all slopes 3:1 or greater and b) 7 calendar days to all other disturbances.  
Temp Seed - 3/1 to 5/15 and 8/1 to 10/15; Perm Seed 3/1 to 5/15 and 8/15 to 10/15

This plan revision must meet the 2011 Maryland Standards and Specifications for Soil Erosion and Sediment Control Sections B-4-2, B-4-3, B-4-4, B-4-5, and where applicable Section B-4-8

THE CONTRACTOR SHALL REFER TO THE 2011 MD STANDARDS AND SPECIFICATIONS FOR SOIL EROSION & SEDIMENT CONTROL FROM [http://howardscd.org/SCD/scd\\_erosandseed\\_documents.htm](http://howardscd.org/SCD/scd_erosandseed_documents.htm) FOR THE CURRENT SEEDING AND STABILIZATION SPECIFICATIONS, SEC. B-4-4 & B-4-5

EP06-009  
THE DEVELOPMENT IS APPROVED FOR EROSION AND SEDIMENT CONTROL BY HOWARD SOIL CONSERVATION DISTRICT.  
Signature of Engineer (print name below signature) DATE  
Howard Soil Conservation District DATE

ENGINEER'S CERTIFICATE  
I certify that this plan for pond construction and for sediment and erosion control represents a practical and workable plan based on my personal knowledge of the site conditions. This plan was prepared in accordance with the requirements of the Howard Soil Conservation District. I have notified the developer that he/she must engage a registered professional engineer to supervise pond construction and provide the Howard Soil Conservation District with an "as-built" plan of the pond within 30 days of completion.

DEVELOPER'S CERTIFICATE  
I/We certify that all development and construction will be done according to these plans, and that any responsible personnel involved in the construction of this project will have a Certificate of Attendance at a Department of Environment Approved Training Program for the Control of Sediment and Erosion before beginning the project. I also authorize periodic on-site inspection by the Howard Soil Conservation District. I shall engage a registered professional engineer to supervise pond construction and provide the Howard Soil Conservation District with an "as-built" plan of the pond within 30 days of completion.

DEPARTMENT OF PUBLIC WORKS  
DIRECTOR OF PUBLIC WORKS DATE  
CHIEF, BUREAU OF ENGINEERING DATE  
CHIEF, DIVISION OF TRANSPORTATION AND SPECIAL PROJECTS DATE

**STANDARD SEDIMENT CONTROL NOTES**

1. A MINIMUM OF 48 HOURS NOTICE MUST BE GIVEN TO THE HOWARD COUNTY DEPARTMENT OF INSPECTIONS, LICENSES AND PERMITS, SEDIMENT CONTROL DIVISION PRIOR TO THE START OF ANY CONSTRUCTION (410-313-1855).

2. ALL VEGETATIVE AND STRUCTURAL PRACTICES ARE TO BE INSTALLED ACCORDING TO THE PROVISIONS OF THIS PLAN AND ARE TO BE IN CONFORMANCE WITH THE 1994 MARYLAND STANDARDS AND SPECIFICATIONS FOR SOIL EROSION AND SEDIMENT CONTROL AND REVISIONS THERE TO.

3. FOLLOWING INITIAL SOIL DISTURBANCE OR REDISTURBANCE, PERMANENT OR TEMPORARY STABILIZATION SHALL BE COMPLETED WITHIN:

A) 3 CALENDAR DAYS FOR ALL PERIMETER SEDIMENT CONTROL STRUCTURES, DIKES, PERIMETER SLOPES, AND ALL SLOPES STEEPER THAN 3:1 BY 7 DAYS AS TO ALL OTHER DISTURBED OR GRADED AREAS ON THE PROJECT SITE.

4. ALL SEDIMENT TRAPS/BASINS SHOWN MUST BE FENCED AND WARNING SIGNS POSTED AROUND THE PERIMETER IN ACCORDANCE WITH VOLUME 1, CHAPTER 7, OF THE HOWARD COUNTY DESIGN MANUAL, STORM DRAINAGE.

5. ALL DISTURBED AREAS MUST BE STABILIZED WITHIN THE TIME PERIOD SPECIFIED ABOVE IN ACCORDANCE WITH THE 2011 MARYLAND STANDARDS AND SPECIFICATIONS FOR SOIL EROSION AND SEDIMENT CONTROL FOR PERMANENT SEEDING, SOD, TEMPORARY SEEDING, AND MULCHING (SECTION B, TEMPORARY SEEDING, B-4-2). STABILIZATION WITH MULCH ALONE SHALL ONLY BE DONE WHEN RECOMMENDED SEEDING DATES DO NOT ALLOW FOR PROPER GERMINATION AND ESTABLISHMENT OF GRASSES.

6. ALL SEDIMENT CONTROL STRUCTURES ARE TO REMAIN IN PLACE AND ARE TO BE MAINTAINED IN OPERATIVE CONDITION UNTIL PERMISSION FOR THEIR REMOVAL HAS BEEN OBTAINED FROM THE HOWARD COUNTY SEDIMENT CONTROL INSPECTOR.

7. SITE ANALYSIS:  
AREA DISTURBED - 0.4 ACRES  
AREAS TO BE ROOFED OR PAVED - 0 ACRES  
AREA TO BE VEGETATIVELY STABILIZED - 0.4 ACRES  
TOTAL CUT - 0 CY  
TOTAL FILL - 0 CY  
OFF-SITE WASTE SITE - HOWARD COUNTY LANDFILL  
OFF-SITE BORROW SITE - APPROVED SITE WITH AN ACTIVE GRADING PERMIT

8. ANY SEDIMENT CONTROL PRACTICE WHICH IS DISTURBED BY GRADING ACTIVITY FOR PLACEMENT OF UTILITIES MUST BE REPAIRED ON THE SAME DAY OF DISTURBANCE.

9. ADDITIONAL SEDIMENT CONTROLS MUST BE PROVIDED, IF DEEMED NECESSARY BY THE HOWARD COUNTY SEDIMENT CONTROL INSPECTOR.

10. ON ALL SITES WITH DISTURBED AREAS IN EXCESS OF 2 ACRES, APPROVAL OF THE INSPECTION AGENCY SHALL BE REQUESTED UPON COMPLETION OF INSTALLATION OF PERIMETER EROSION AND SEDIMENT CONTROLS, BUT BEFORE PROCEEDING WITH ANY OTHER EARTH DISTURBANCE OR GRADING, OTHER BUILDING OR GRADING INSPECTION APPROVALS MAY NOT BE AUTHORIZED UNTIL THIS INITIAL APPROVAL BY THE INSPECTION AGENCY IS MADE.

11. TRENCHES FOR THE CONSTRUCTION OF UTILITIES IS LIMITED TO THREE PIPE LENGTHS OR THAT WHICH SHALL BE BACKFILLED AND STABILIZED WITHIN ONE WORKING DAY, WHICHEVER IS SHORTER.

12. SITE GRADING WILL BEGIN ONLY AFTER ALL PERIMETER SEDIMENT CONTROL MEASURES HAVE BEEN INSTALLED AND ARE IN A FUNCTIONING CONDITION.

13. SEDIMENT WILL BE REMOVED FROM TRAPS WHEN ITS DEPTH REACHES CLEAN OUT ELEVATION SHOWN ON THE PLANS.

14. CUT AND FILL QUANTITIES PROVIDED UNDER SITE ANALYSIS DO NOT REPRESENT BID QUANTITIES. THESE QUANTITIES DO NOT DISTINGUISH BETWEEN TOPSOIL, STRUCTURAL FILL OR EMBANKMENT MATERIAL, NOR DO THEY REFLECT CONSIDERATION OF UNDERCUTTING OR REMOVAL OF UNSUITABLE MATERIAL. THE CONTRACTOR SHALL FAMILIARIZE HIMSELF WITH SITE CONDITIONS WHICH MAY AFFECT THE WORK.

15. CONSTRUCTION WITHIN, ALONG OR ACROSS STREAM CHANNELS SHALL, AS A MINIMUM, CONFIRM TO CRITERIA DESCRIBED UNDER "MARYLAND'S GUIDELINES TO WATERWAY CONSTRUCTION".

Stabilization must be completed within: a) 3 calendar days to all perimeter controls, all slopes 3:1 or greater and b) 7 calendar days to all other disturbances.  
Temp Seed - 3/1 to 5/15 and 8/1 to 10/15; Perm Seed 3/1 to 5/15 and 8/15 to 10/15

This plan revision must meet the 2011 Maryland Standards and Specifications for Soil Erosion and Sediment Control Sections B-4-2, B-4-3, B-4-4, B-4-5, and where applicable Section B-4-8

NOTES: FOR SYMBOL DESIGN CONTACT SHA SIGN SHOP.

REFERENCES: MDMTCD SECTION- GF.34  
COLORS: LEGEND - BLACK BACKGROUND - FLUORESCENT ORANGE

TRUCK CROSSING SIGN  
SIGN SIZE DIMENSIONS (INCHES)  
A B C D E  
STD 48 3/4 1-1/4 20 5

DEPARTMENT OF PUBLIC WORKS  
DIRECTOR OF PUBLIC WORKS DATE  
CHIEF, BUREAU OF ENGINEERING DATE  
CHIEF, DIVISION OF TRANSPORTATION AND SPECIAL PROJECTS DATE

DEPARTMENT OF PUBLIC WORKS  
DIRECTOR OF PUBLIC WORKS DATE  
CHIEF, BUREAU OF ENGINEERING DATE  
CHIEF, DIVISION OF TRANSPORTATION AND SPECIAL PROJECTS DATE

**SEQUENCE OF CONSTRUCTION**

NOTE THAT SOME SEQUENCE STEPS MAY BE PERFORMED CONCURRENTLY WITH THE APPROVAL OF THE COUNTY INSPECTOR.

PHASE I:  
1. OBTAIN THE NECESSARY GRADING PERMITS PRIOR TO CONSTRUCTION (1 DAY).

2. NOTIFY HOWARD COUNTY AT 410-313-1855 AT LEAST 48 HOURS PRIOR TO THE START OF CONSTRUCTION (1 DAY). REQUEST A PRE-CONSTRUCTION MEETING.

3. WITH THE APPROVAL OF THE INSPECTOR INSTALL STABILIZED CONSTRUCTION ENTRANCES WITH MOUNTABLE BERMS AND PIPES (IF NECESSARY). (2 DAYS)

4. CLEAR AND GRUB FOR THE INSTALLATION OF THE EROSION AND SEDIMENT CONTROL MEASURES NOTED BELOW. (5 DAYS)

5. INSTALL PIPE DIVERSION PRACTICES TO FACILITATE THE INSTALLATION OF THE 48-INCH HDPE PIPES.

6. INSTALL THE FOLLOWING PERIMETER EROSION AND SEDIMENT CONTROL MEASURES (10 DAYS):  
A. SILT FENCE

7. ESTABLISH STAGING AREA(S) FOR CONSTRUCTION TRAILERS AND COORDINATE UTILITY SERVICES. (5 DAYS)

8. COORDINATE THE DISCONNECTION OF ALL EXISTING UTILITIES (IF NOT DONE SO ALREADY) TO EXISTING DWELLINGS WITHIN THE LIMIT OF DISTURBANCE.

9. WITH THE APPROVAL OF THE SEDIMENT CONTROL INSPECTOR, INSTALL STORM DRAIN SYSTEM FROM EX. MH-II TO EX. MH-13. REMOVE EXISTING STORM DRAIN SYSTEM FROM EX. MH-II TO EX. MH-13. (10 DAYS)

10. WITH THE APPROVAL OF THE INSPECTOR, REMOVE ALL REMAINING SEDIMENT CONTROL DEVICES AND COMPLETE THE FINAL STABILIZATION. (5 DAYS)

NOTE: ANY CHANGES OR REVISIONS TO THE SEQUENCE OF CONSTRUCTION MUST BE REVIEWED AND APPROVED BY HOWARD COUNTY PRIOR TO PROCEEDING WITH CONSTRUCTION.

Stabilization must be completed within: a) 3 calendar days to all perimeter controls, all slopes 3:1 or greater and b) 7 calendar days to all other disturbances.  
Temp Seed - 3/1 to 5/15 and 8/1 to 10/15; Perm Seed 3/1 to 5/15 and 8/15 to 10/15

This plan revision must meet the 2011 Maryland Standards and Specifications for Soil Erosion and Sediment Control Sections B-4-2, B-4-3, B-4-4, B-4-5, and where applicable Section B-4-8

NOTES: FOR SYMBOL DESIGN CONTACT SHA SIGN SHOP.

REFERENCES: MDMTCD SECTION- GF.34  
COLORS: LEGEND - BLACK BACKGROUND - FLUORESCENT ORANGE

TRUCK CROSSING SIGN  
SIGN SIZE DIMENSIONS (INCHES)  
A B C D E  
STD 48 3/4 1-1/4 20 5

DEPARTMENT OF PUBLIC WORKS  
DIRECTOR OF PUBLIC WORKS DATE  
CHIEF, BUREAU OF ENGINEERING DATE  
CHIEF, DIVISION OF TRANSPORTATION AND SPECIAL PROJECTS DATE

DEPARTMENT OF PUBLIC WORKS  
DIRECTOR OF PUBLIC WORKS DATE  
CHIEF, BUREAU OF ENGINEERING DATE  
CHIEF, DIVISION OF TRANSPORTATION AND SPECIAL PROJECTS DATE

**Maryland's Guidelines To Waterway Construction  
DETAIL 1.2: PUMP-AROUND PRACTICE**

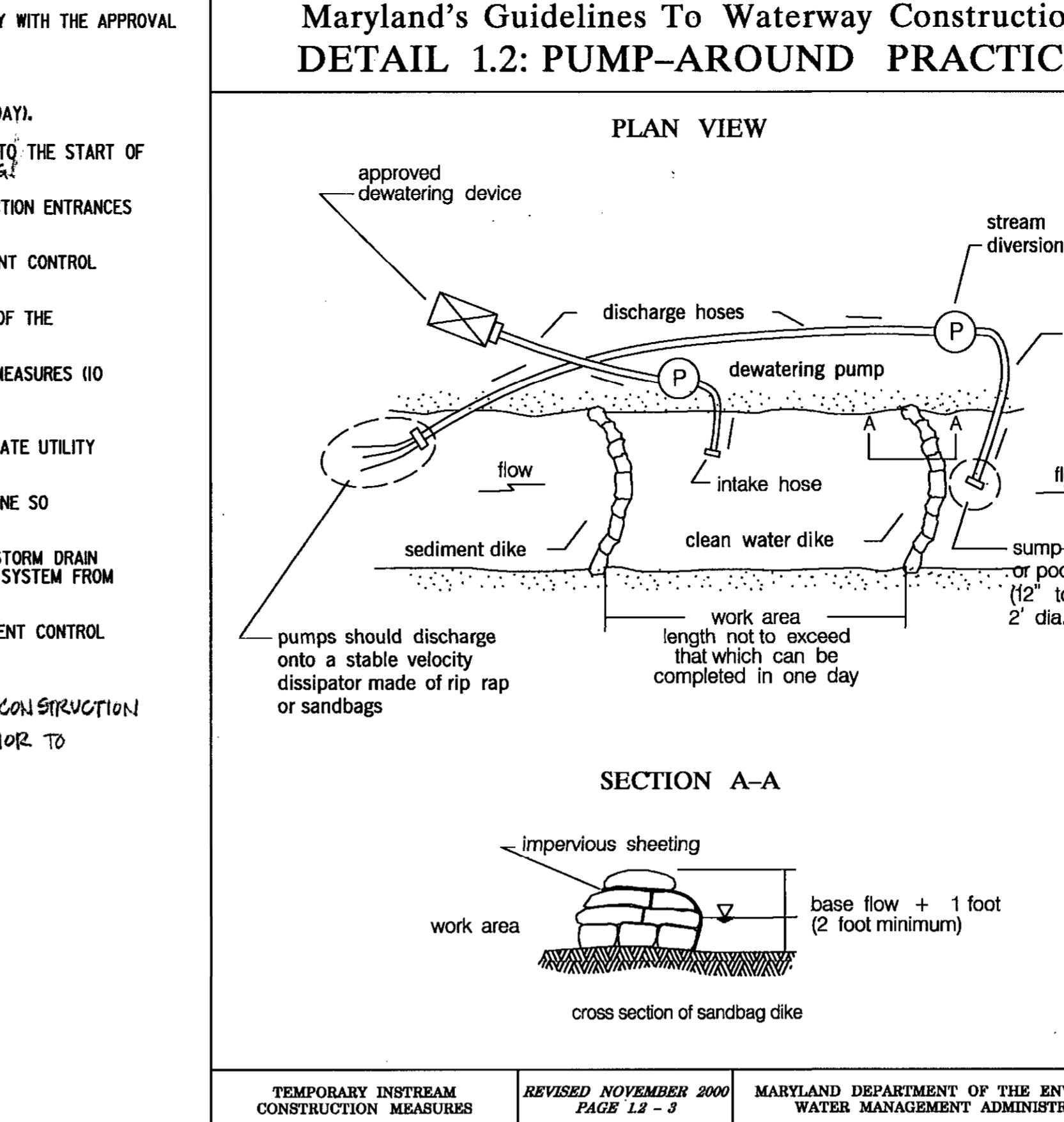

TEMPORARY INSTREAM CONSTRUCTION MEASURES  
REVISED NOVEMBER 2000 PAGE 1.2 - 3  
MARYLAND DEPARTMENT OF THE ENVIRONMENT WATER MANAGEMENT ADMINISTRATION

**TEMPORARY TRAFFIC CONTROL TYPICAL APPLICATION**

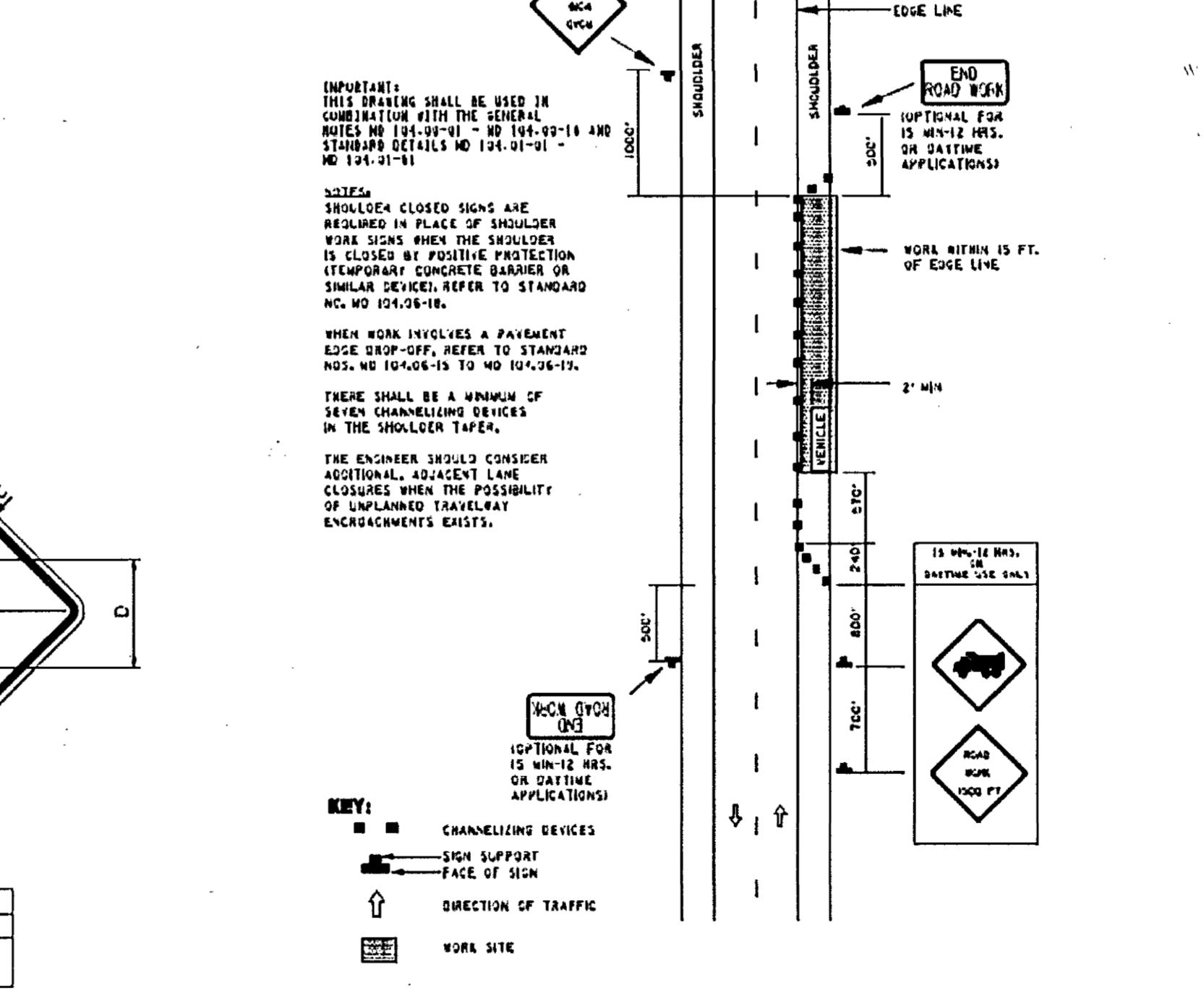

SHOULDER WORK /2-LANE, 2-WAY GREATER THAN 40 MPH  
NOT TO SCALE

CONTRACTOR SHALL UTILIZE THE LATEST DETAILS FOR THE STABILIZED CONSTRUCTION ENTRANCE (DETAIL E-1), SILT FENCE (DETAIL E-1), AND SUPER SILT FENCE (DETAIL E-3) FROM THE 2011 MD STANDARDS AND SPECIFICATIONS FOR SOIL EROSION & SEDIMENT CONTROL BY OBTAINING THEM FROM [http://howardscd.org/SCD/scd\\_erosandseed\\_documents.htm](http://howardscd.org/SCD/scd_erosandseed_documents.htm). THE CONTRACTOR WILL RECEIVE COPIES AT THE PRE-CONSTRUCTION MEETING.

DEPARTMENT OF PUBLIC WORKS  
DIRECTOR OF PUBLIC WORKS DATE  
CHIEF, BUREAU OF ENGINEERING DATE  
CHIEF, DIVISION OF TRANSPORTATION AND SPECIAL PROJECTS DATE

**DETAIL 24 - STABILIZED CONSTRUCTION ENTRANCE \***

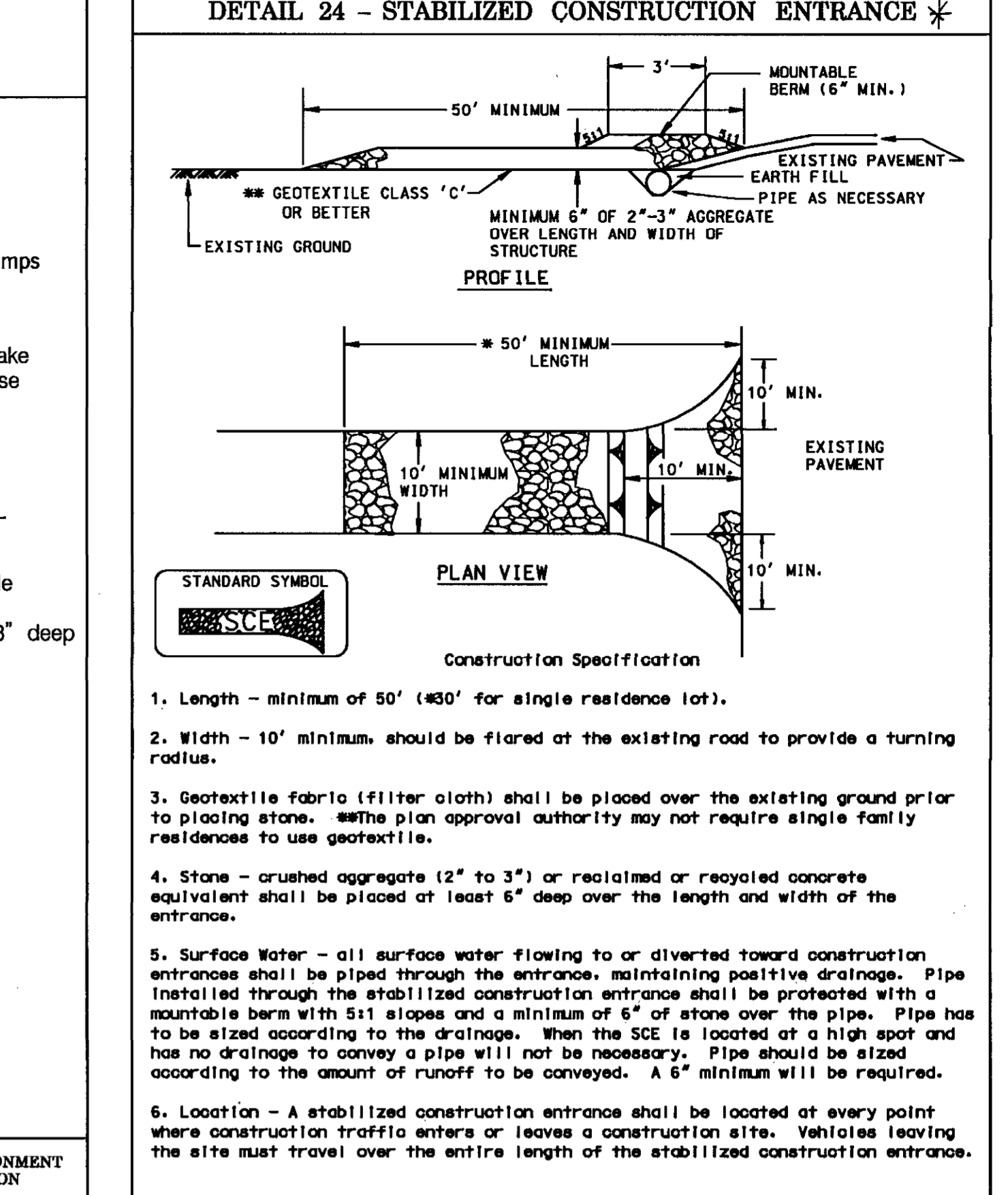

U.S. DEPARTMENT OF AGRICULTURE SOIL CONSERVATION SERVICE  
PAGE 17 - 3  
MARYLAND DEPARTMENT OF ENVIRONMENT WATER MANAGEMENT ADMINISTRATION

**DETAIL 22 - SILT FENCE \***

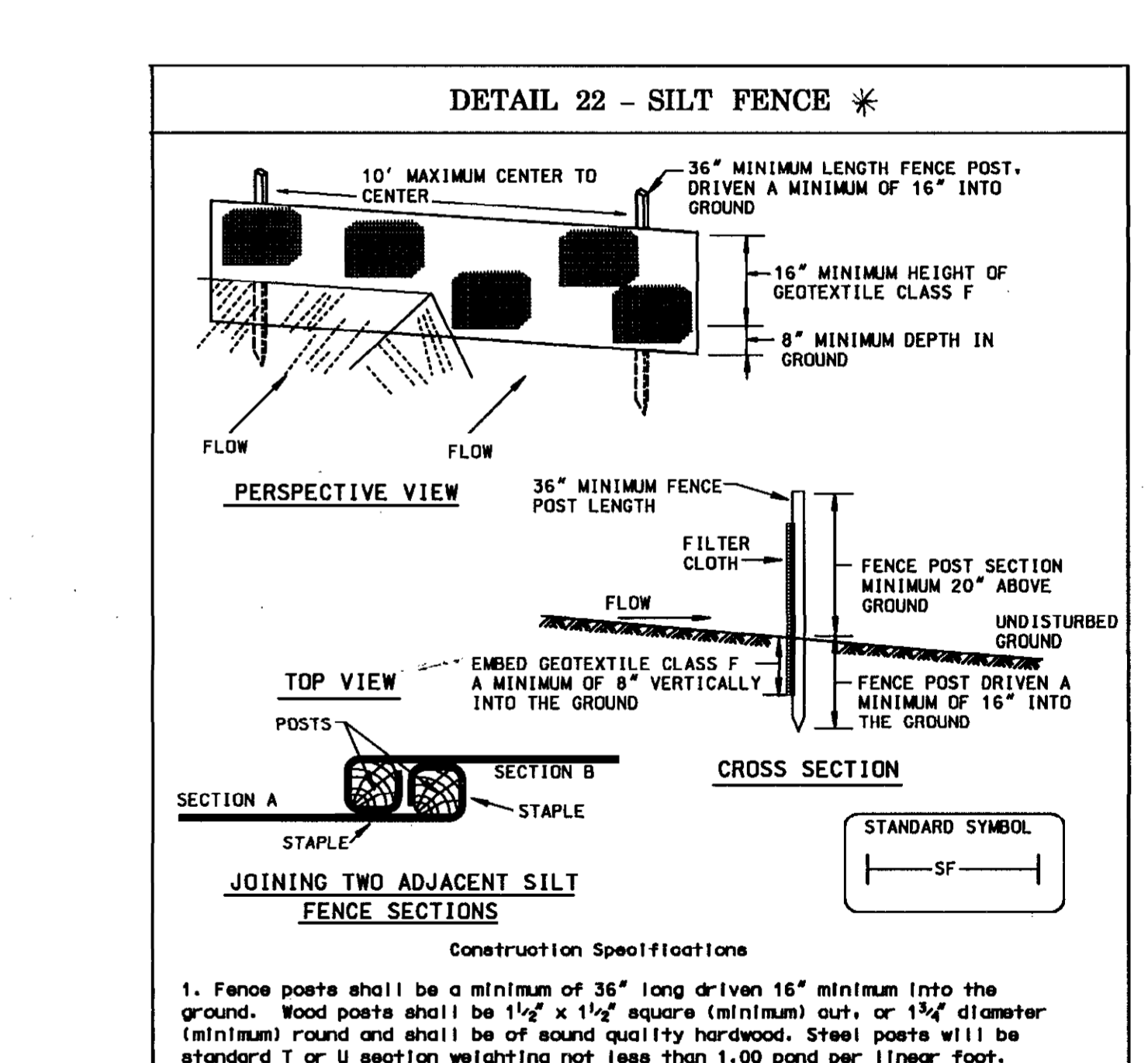

U.S. DEPARTMENT OF AGRICULTURE SOIL CONSERVATION SERVICE  
PAGE 16 - 3  
MARYLAND DEPARTMENT OF ENVIRONMENT WATER MANAGEMENT ADMINISTRATION

CONTRACTOR SHALL UTILIZE THE LATEST DETAILS FOR THE STABILIZED CONSTRUCTION ENTRANCE (DETAIL E-1), SILT FENCE (DETAIL E-1), AND SUPER SILT FENCE (DETAIL E-3) FROM THE 2011 MD STANDARDS AND SPECIFICATIONS FOR SOIL EROSION & SEDIMENT CONTROL BY OBTAINING THEM FROM [http://howardscd.org/SCD/scd\\_erosandseed\\_documents.htm](http://howardscd.org/SCD/scd_erosandseed_documents.htm). THE CONTRACTOR WILL RECEIVE COPIES AT THE PRE-CONSTRUCTION MEETING.

DEPARTMENT OF PUBLIC WORKS  
DIRECTOR OF PUBLIC WORKS DATE  
CHIEF, BUREAU OF ENGINEERING DATE  
CHIEF, DIVISION OF TRANSPORTATION AND SPECIAL PROJECTS DATE

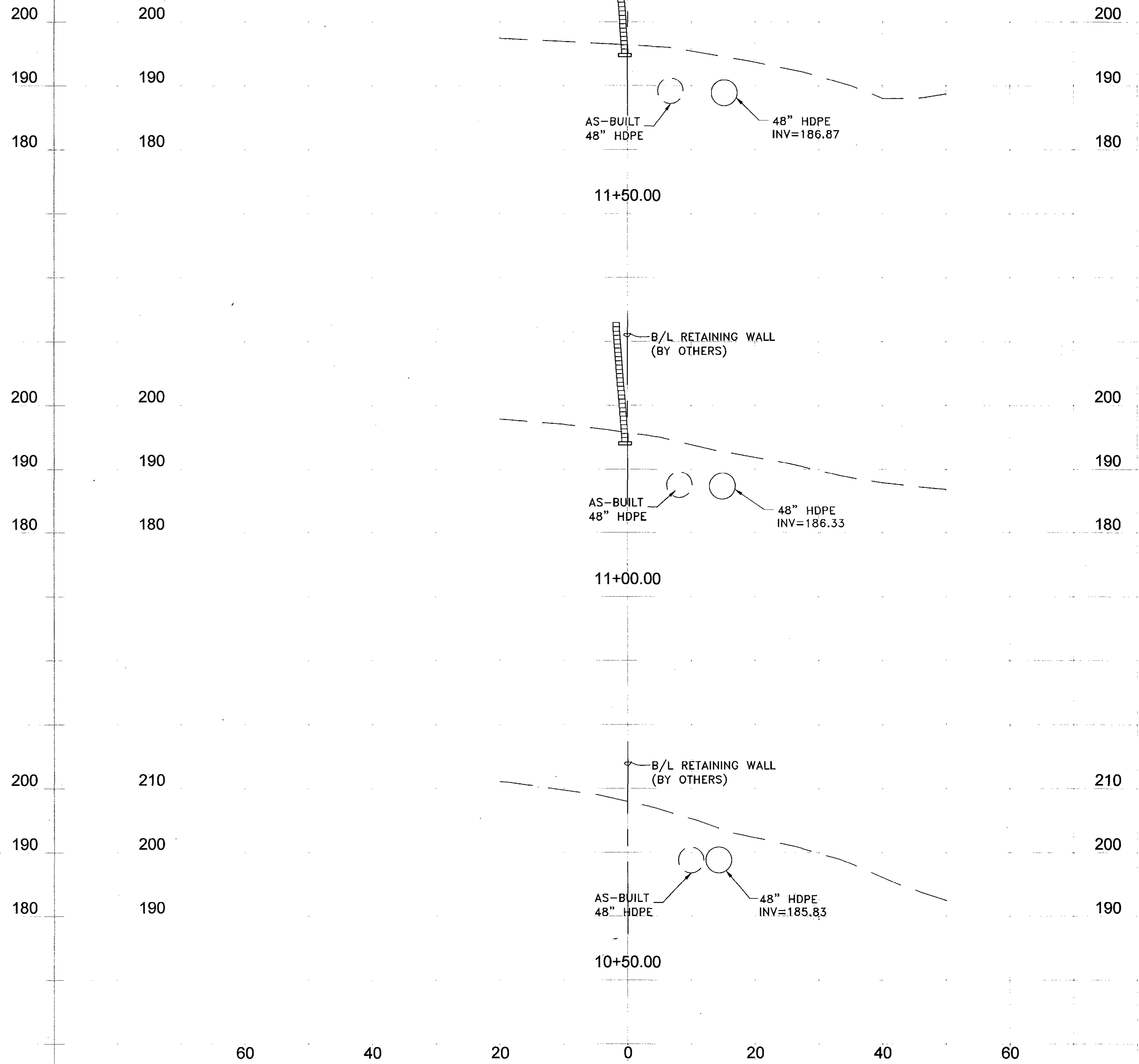
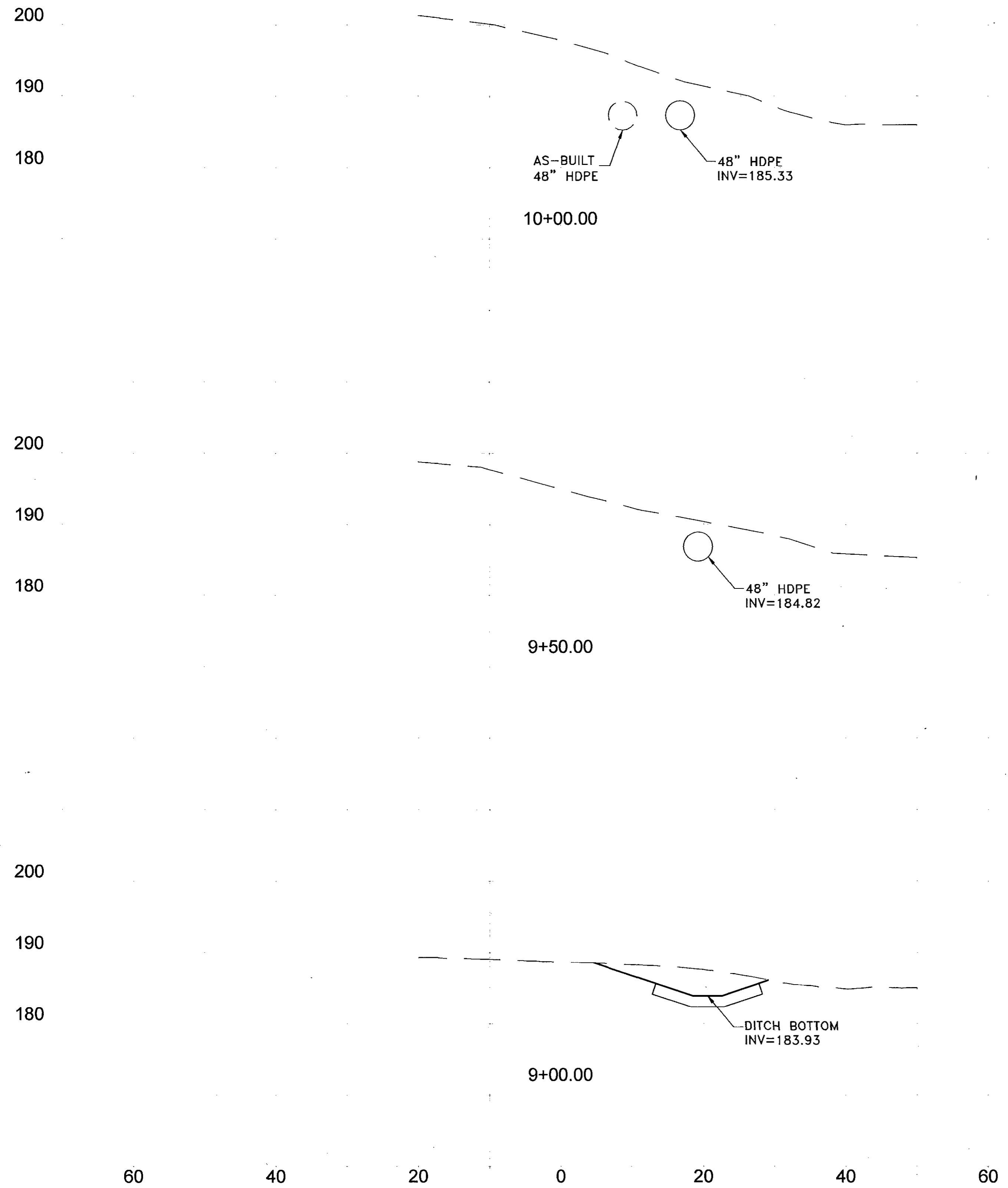

DEPARTMENT OF PUBLIC WORKS

*Ray D. ...*  
 DIRECTOR OF PUBLIC WORKS  
 DATE: 2/20/14  
 CHIEF, DIVISION OF TRANSPORTATION AND SPECIAL PROJECTS

*Thomas E. Butler*  
 CHIEF, BUREAU OF ENGINEERING  
 DATE: 2-27-14  
 CHIEF, BUREAU OF HIGHWAYS

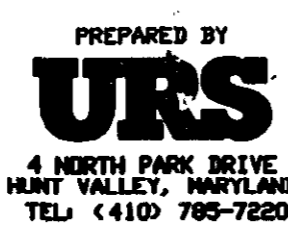

DES:	RLL		
DRN:	CDF		
CHK:	DTM		
DATE:	11/12		
BY:	NO.	REVISION	DATE

CROSS SECTIONS

SCALE MAP NO. N/A BLOCK NO.

DORSEY RUN ROAD EXTENSION  
 MD 175 TO  
 DORSEY RUN INDUSTRIAL CENTER  
 ELECTION DISTRICT NO. 1 - JESSUP, MARYLAND  
 CAPITAL PROJECT J-4148

SCALE

SHEET 6 OF 7

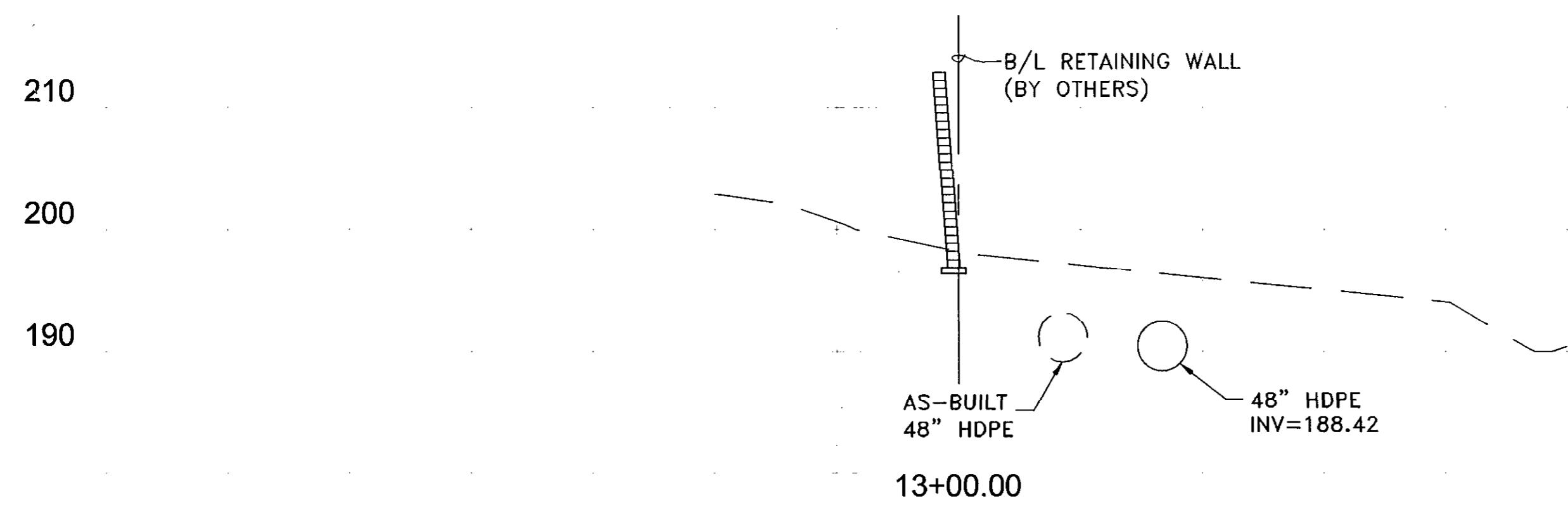

210  
200  
190

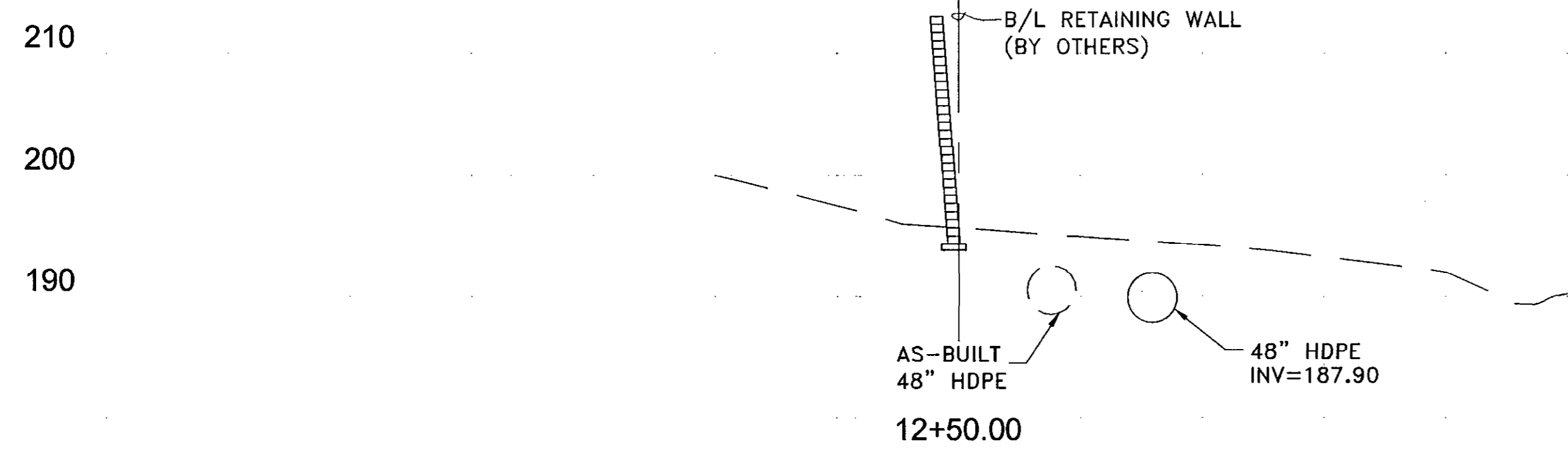

210  
200  
190

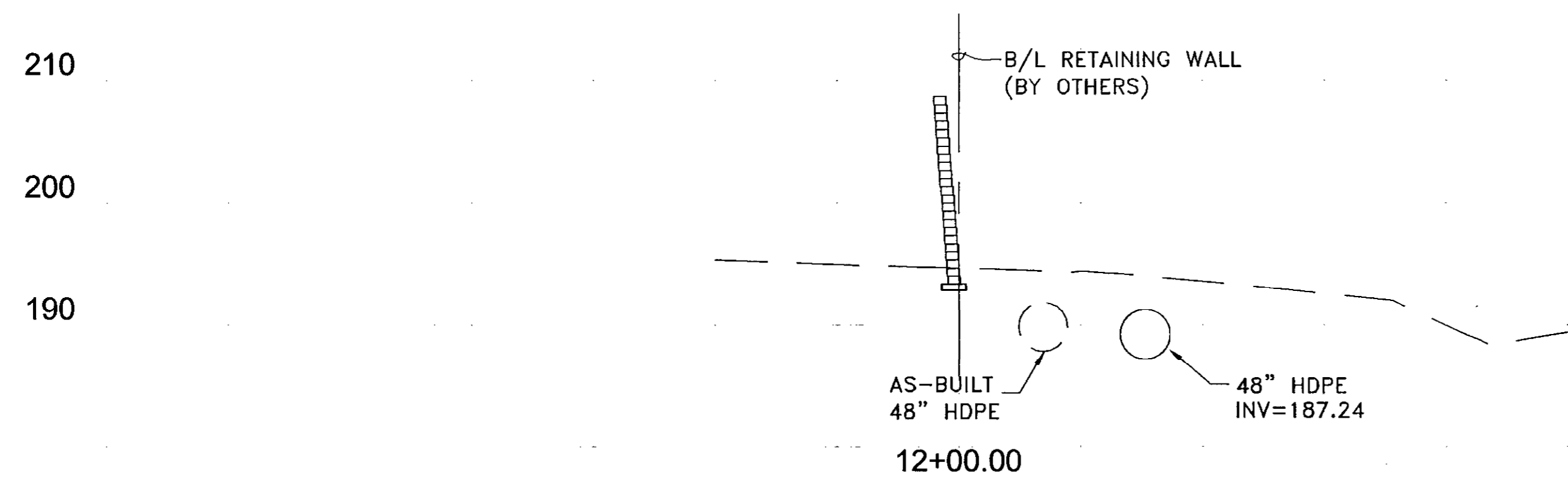

210  
200  
190

60 40 20 0 20 40 60 60 40 20 0 20 40 60

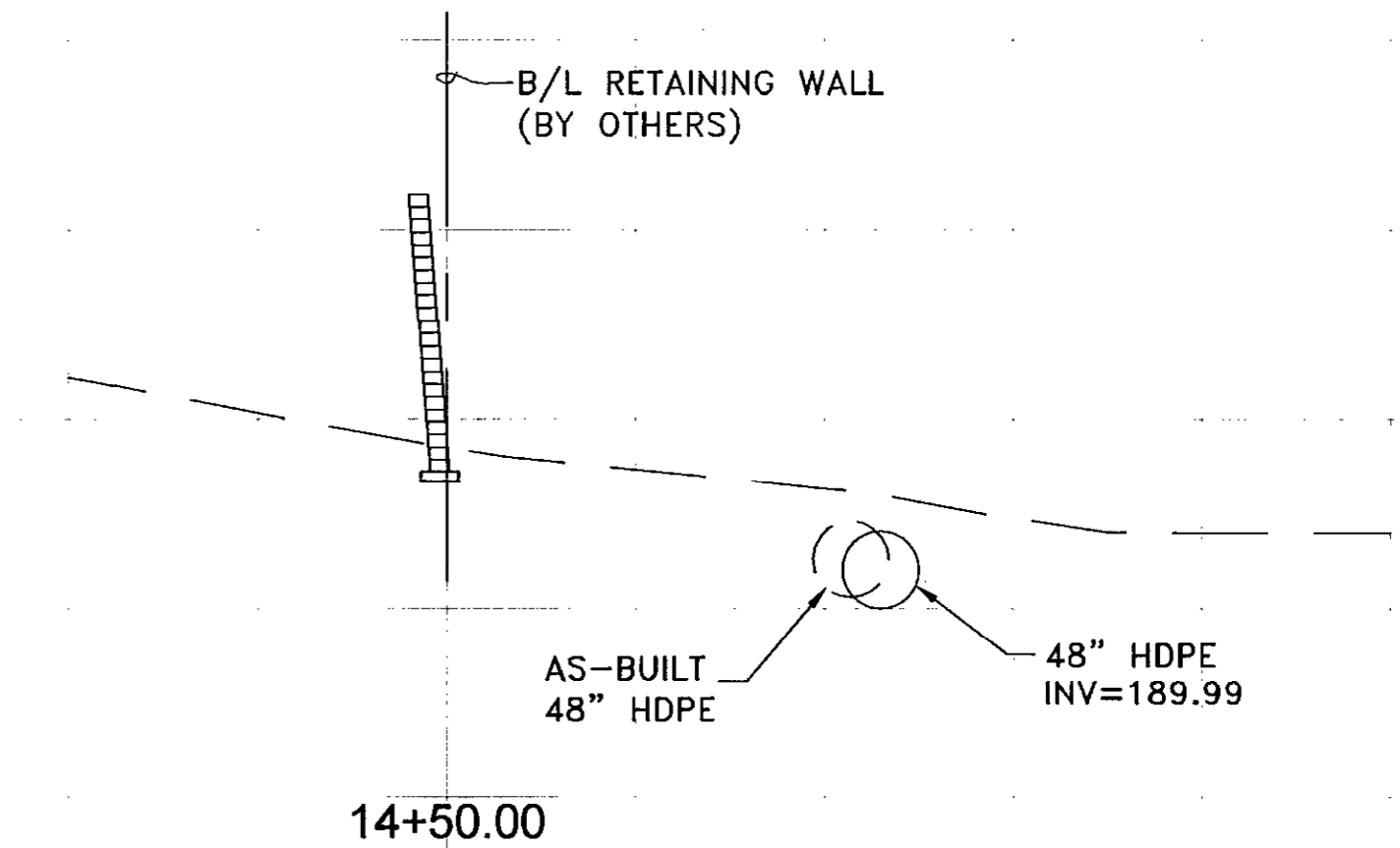

210  
200  
190

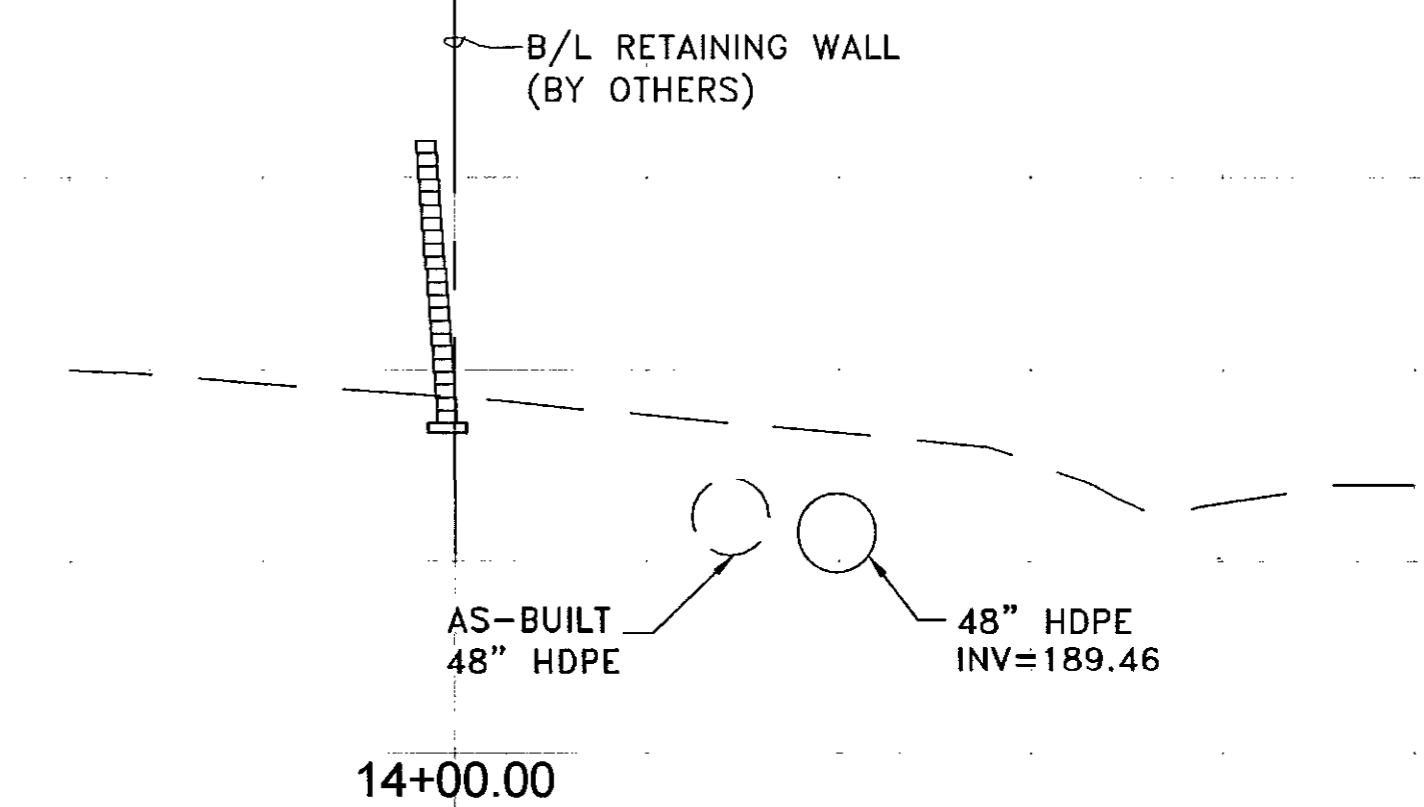

210  
200  
190

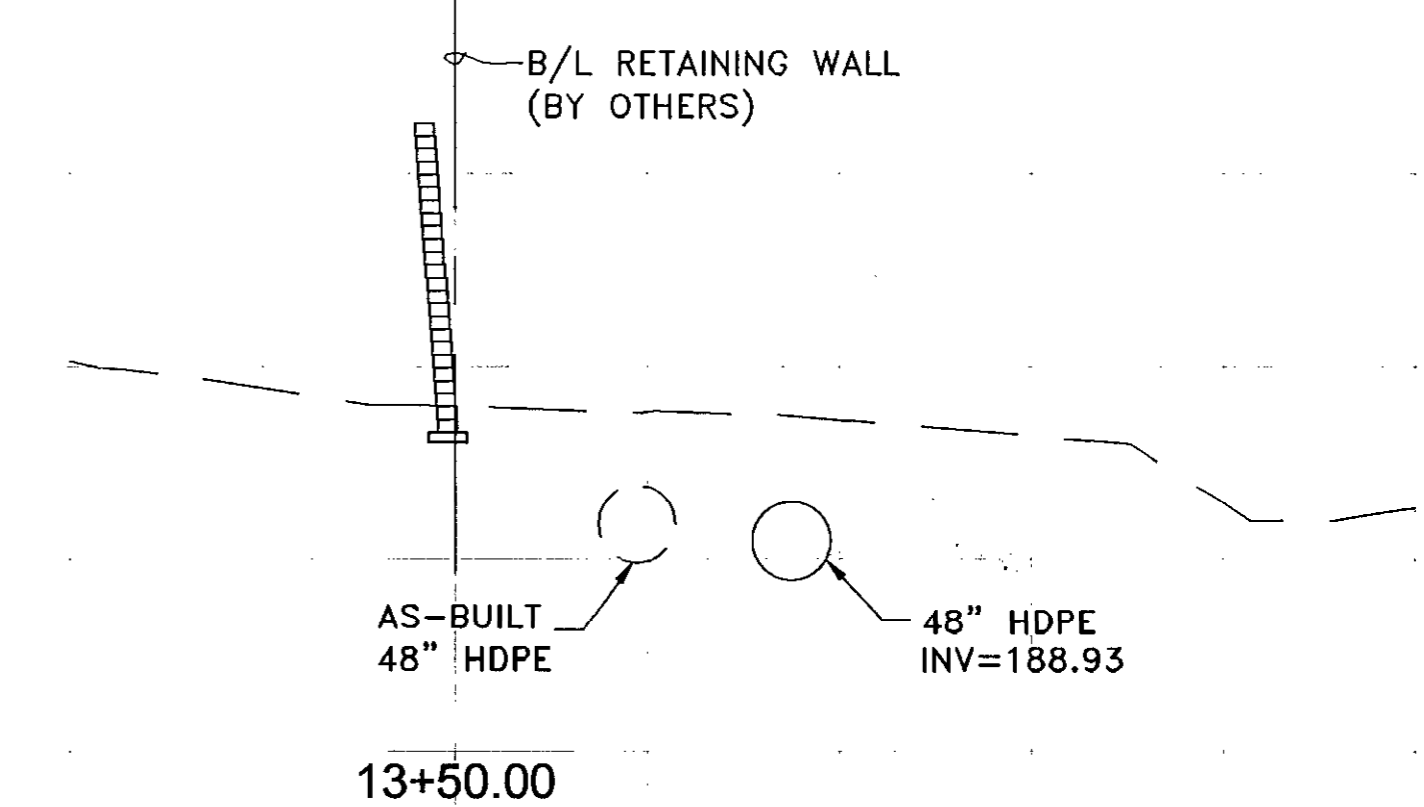

210  
200  
190

Professional Seal and Signature: I certify that these documents were prepared by me, and that I am a duly licensed professional engineer under the laws of the State of Maryland.  
License No. 16156 Expiration Date: 2-28-14

DEPARTMENT OF PUBLIC WORKS  
 Director of Public Works: *Steve Shavar* 2/25/14  
 Chief, Bureau of Engineering: *Michael Kelly* 2/25/14  
 Chief, Division of Transportation and Special Projects: *Steve Shavar* 2/25/14  
 Chief, Bureau of Highways: *Walter J. Kelly* 2-27-14

PREPARED BY  
**URS**  
 4 NORTH PARK DRIVE  
 HUNT VALLEY, MARYLAND  
 TEL: (410) 789-7220

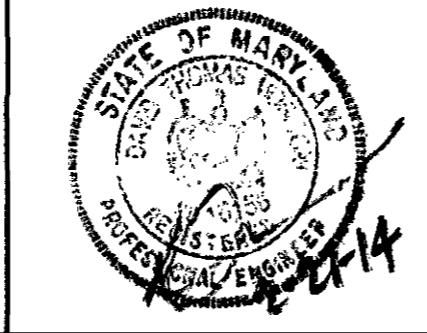

DES:	RLL		
DRN:	CDF		
CHK:	DTM		
DATE:	11/12		
BY:	NO.	REVISION	DATE

**CROSS SECTIONS**  
 SCALE MAP NO. N/A BLOCK NO.

**DORSEY RUN ROAD EXTENSION  
 MD 175 TO  
 DORSEY RUN INDUSTRIAL CENTER**  
 ELECTION DISTRICT NO. 1 - JESSUP, MARYLAND  
 CAPITAL PROJECT J-4148

SCALE  
 SHEET 7 OF 7